

User-specified Fish (FGEN) Data Entry Form

Fish sample collection methods and protocols

- **NOTE:** Don't use the User-specified Fish (FGEN) forms for NAWQA or NRSA fish community samples

- Creating a User-Specified Fish (FGEN) Sample
- Selecting a Sampling Method Reference (required)
- Displaying Information about Methods and Protocols
- Selecting Sampling Target (required)
- Entering Details about Sampling Effort
- User-defined Flags for Fish Records

Required Fields:

- USGS Station ID
- Collection Date
- Start Time
- Time Datum
- Sampling Method Reference
- Sampling Target
- Reach Length Fished

Creating a User-Specified Fish (FGEN) Sample

- **NOTE:** *Site* and *Collection Date* must be entered before the [Create](#) "button" will appear

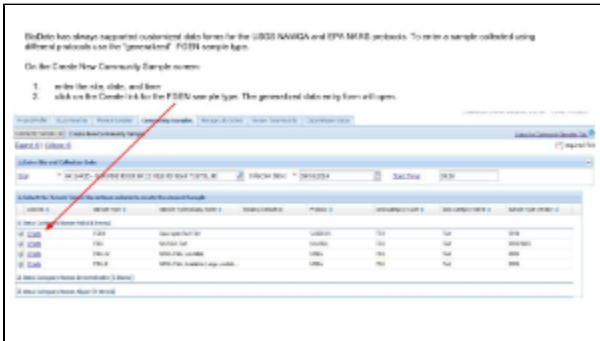
A screenshot of the FGEN data entry form. The form is titled "Biodata form always captured collection data forms for the USGS NAWQA and EPA MFRB protocols. To enter a sample collected using different protocols use the 'generalized' FGEN sample type." Below this, there are instructions: "On the Create New Community Sample screen: 1. enter the site, date, and time 2. click on the Create link for the FGEN sample type. The generalized data entry form will open." The form itself has several sections: "USGS Station ID", "Collection Date", "Start Time", "Time Datum", "Sampling Method Reference", "Sampling Target", and "Reach Length Fished". A red arrow points to the "Create" button at the bottom right of the form.

Click on the image to expand

Selecting a Sampling Method Reference (required)

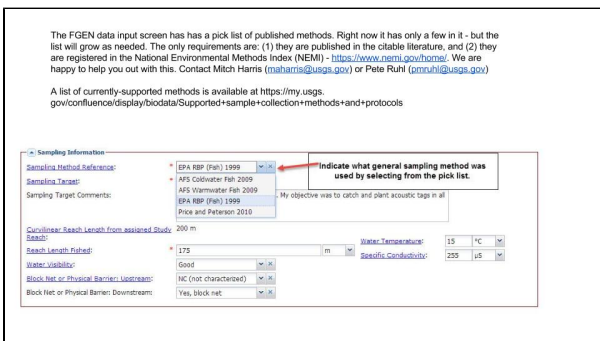
A screenshot of the FGEN data entry form, specifically the "Sampling Information" section. The "Sampling Method Reference" dropdown menu is open, showing a list of methods: "EPA RPB (Pah) 1999", "AFS Collector Fish 2009", "AFS Streamwater Fish 2009", "EPA RPB (Pah) 1999", and "Price and Peterson 2010". A red arrow points to the "EPA RPB (Pah) 1999" option, with a text box that says "Indicate what general sampling method was used by selecting from the pick list." Below the dropdown, there are fields for "Sampling Target Comments" (with the text "My objective was to catch and plant acoustic tags in all"), "Current/Reach Length from assigned Study" (200 m), "Reach Length Fished" (175 m), "Water Temperature" (15 °C), "Specific Conductivity" (230 µS), "Water Visibility" (Good), "Block Net or Physical Barrier Upstream" (No), and "Block Net or Physical Barrier Downstream" (Yes, block net).

Click on the image to expand

Displaying Information about Methods and Protocols

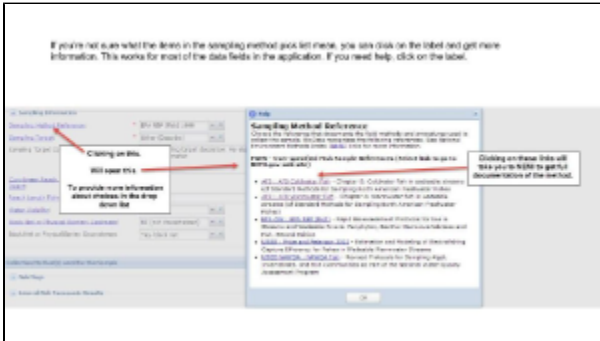

Click on the image to expand

Selecting Sampling Target (required)

- NOTE: Reach Length Fished is also a required field



Click on the image to expand

Entering Details about Sampling Effort



Click on the image to expand

User-defined Flags for Fish Records

Want to keep track of something other than routine abundance, length, weight, and DGLT anomalies? You can use predefined global keywords to all projects and user defined tags for your assets to tag your fish records so you can capture that extra bit of information.

The screenshot shows a 'Fish Record' form with several sections: 'Fish Record', 'Fish Details', 'Fish Location', and 'Fish Status'. A callout box with a red border and arrows pointing to the 'Tags' field in the 'Fish Record' section contains the following text:

- Use any defined tags
- Or create your own
- Multiple tags are supported

Below the form is a table with columns: 'Date', 'Asset', 'Status', 'Abundance', 'Length', 'Weight', 'DGLT', 'Project', 'Tag', and 'Notes'. The 'Tag' column contains values like 'None', 'None', 'None', 'None', and 'None'. A red circle highlights the 'Tag' column header.

Click on the image to expand